

BAYWINDS R.P.D. PLAT NO. 4

BEING A PORTION OF SECTION 19, TOWNSHIP 43 SOUTH, RANGE 42 EAST,
 LYING IN SECTION 19, TOWNSHIP 43 SOUTH, RANGE 42 EAST,
 CITY OF WEST PALM BEACH, PALM BEACH COUNTY, FLORIDA.
 SHEET 2 OF 7

103

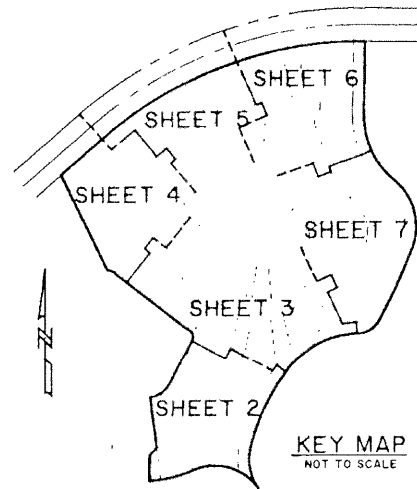

STATE OF FLORIDA
 COUNTY OF PALM BEACH
 THIS PLAT WAS FILED FOR RECORD AT _____
 M. THE DAY OF _____ 2001
 AND DULY RECORDED IN PLAT BOOK NO. _____
 ON PAGE _____
 DOROTHY H. WILKEN, CLERK OF THE CIRCUIT COURT
 BY _____ D.C.

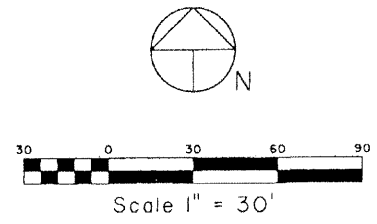

NOT PLATTED

NOT PLATTED
 CONSERVATION EASEMENT
 (O.R.B. 11532, PAGE 984)

BAYWINDS DRIVE
 (PLAT BOOK 84, PAGES 137 - 143)

BAYWINDS R.P.D. PLAT NO. 1
 (PLAT BOOK 84, PAGES 137 - 143)

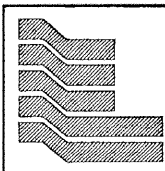

Landmark Surveying & Mapping Inc.
 1850 Forest Hill Boulevard
 Ph. (561) 433-5405 Suite 100 W.P.B. Florida
 LB # 4396
BAYWINDS R.P.D. PLAT NO. 4
 (TRACT C)